

PROJECT: [REDACTED]

NOTES:

- DO NOT SCALE FROM THESE DRAWINGS.
- ALL ANGLES ARE 45deg. UNLESS NOTED.
- DIMENSIONS ARE TO FACE OF FRAMING, CONCRETE &/OR FACE OF ICF FORM.
- GRADES SHOWN ON ELEVATIONS ARE FOR ILLUSTRATIVE PURPOSES ONLY. ADJUST ON SITE AS REQUIRED.
- CONCRETE FOOTINGS MUST BE PLACED ON UNDISTURBED EARTH OR COMPACTED FILL AT AN ELEVATION BELOW THE FROST LINE.
- BACKFILL SHALL NOT BE PLACED AGAINST THE FOUNDATION WALLS UNTIL STRUCTURAL FLOOR FRAMING INCLUDING PLYWOOD SUBFLOOR IS COMPLETE & FULLY NAILED & ANCHORED.
- ALL WOOD IN CONTACT WITH CONCRETE SHALL BE PRESSURE TREATED.
- TRUSS MANUFACTURER TO PROVIDE CERTIFICATES FOR ALL ROOF TRUSSES, FLOOR SYSTEM & LVL DESIGN & SPECIFICATION.
- ALL INTERIOR FINISHES TO BE SELECTED & SPECIFIED BY OWNER.
- ALL EXTERIOR FINISHES TO BE SELECTED & SPECIFIED BY OWNER.
- KITCHEN CABINETS, BATHROOM VANITIES, PLUMBING & LIGHT FIXTURES T BE SELECTED BY OWNER.
- LOCATIONS OF LIGHT FIXTURES, SWITCHES & ELECTRICAL RECEPTACLES TO BE DETERMINED ON SITE IN CONSULTATION WITH OWNER.
- HEATING & AIR EXCHANGE SYSTEMS TO BE INSTALLED IN ACCORDANCE WITH MANUFACTURERS SPECIFICATIONS & NATIONAL BUILDING CODE REQUIREMENTS.
- SMOKE DETECTORS TO BE INSTALLED IN ACCORDANCE WITH LOCAL REGULATIONS & NATIONAL BUILDING CODE REQUIREMENTS.
- ELECTRICAL INSTALLATION TO COMPLY WITH THE CURRENT EDITION OF THE NATIONAL BUILDING CODE.
- ALL HEADERS & TRIMMERS TO COMPLY WITH THE NATIONAL BUILDING CODE LATEST EDITION.
- MATERIALS FOR DECK CONSTRUCTION TO BE DETERMINED BY OWNER & INSTALLED BY BUILDER.

LEGEND:

[Hatched Pattern] INDICATES 2x4 LOADBEARING WALL UNLESS NOTED.
[Hatched Pattern] BEARING WALLS TO HAVE TO HAVE 2-TOP PLATES W/STUDS 16"o.c.
[Hatched Pattern] BEARING WALLS TO BE ON 16" w x 8" d CONCRETE FOOTINGS WHEN INDICATED IN BASEMENT.

STATUS:	FILE: MAHONEY_A7
DATE: MARCH 2022	DESIGN: DBD
SCALE: 3/16"=1'-0"	DRAWN: DBD

DRAWING: Roof Plan	SHEET: A7
--------------------	-----------

[REDACTED]

NOTE:
DASHED LINE INDICATES EXTERIOR FACE
OF HOUSE BELOW

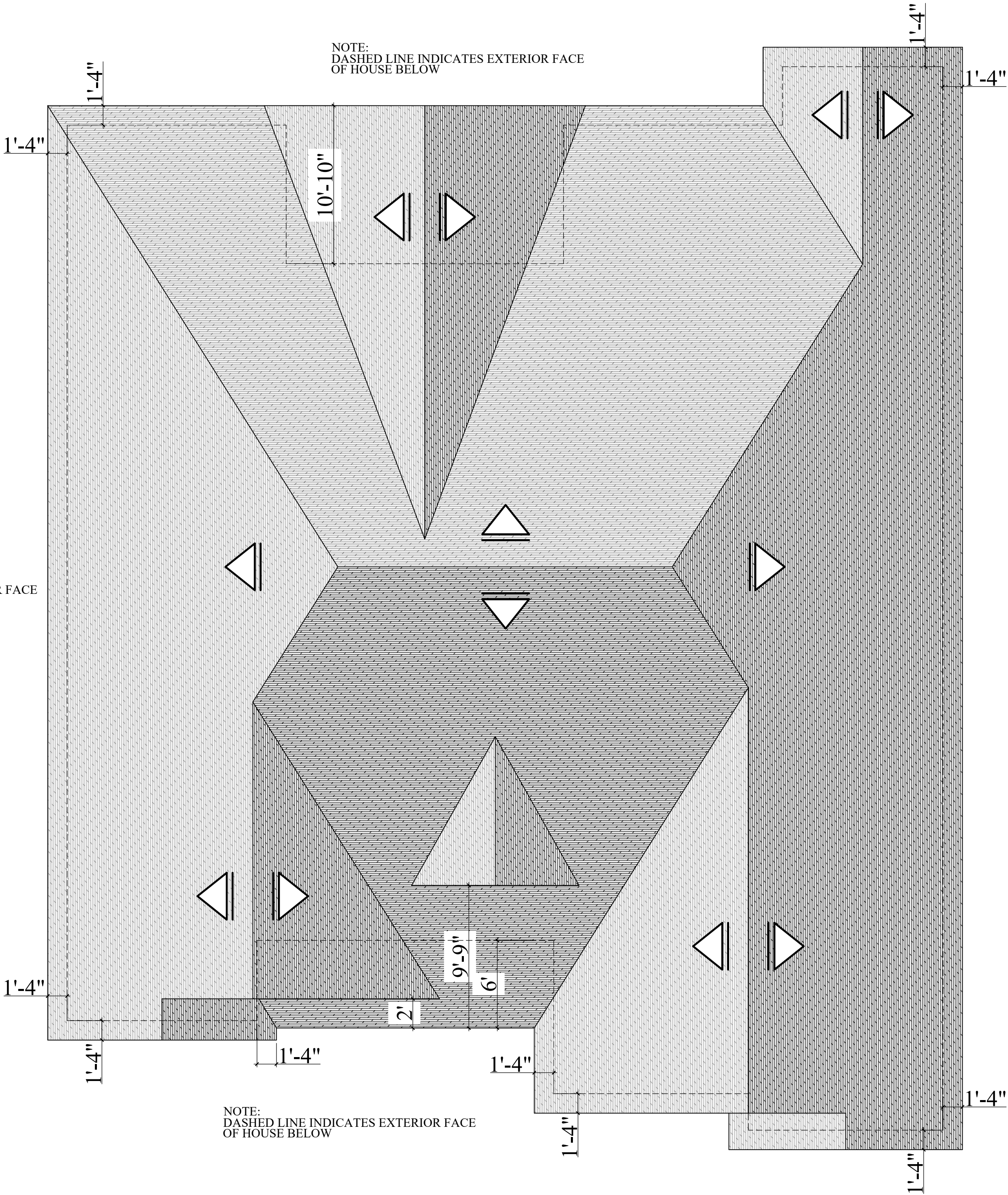

NOTE:
DASHED LINE INDICATES EXTERIOR FACE
OF HOUSE BELOW

NOTE:
DASHED LINE INDICATES EXTERIOR FACE
OF HOUSE BELOW

THESE DRAWINGS ARE TO BE CONSIDERED AS A GUIDE TO COMPETENT CONTRACTORS KNOWLEDGABLE IN WOOD FRAME & ICF CONSTRUCTION METHODS. CONTRACTOR IS RESPONSIBLE FOR CONFIRMING FULL PROJECT SCOPE WITH THE OWNER.

GREAT CARE HAS BEEN TAKEN IN THE PREPARATION OF THESE PLANS. HOWEVER DUE TO THE NATURE OF DESIGN AND CONSTRUCTION PROCEDURES OMISSIONS AND ERRORS MAY STILL OCCUR. IT IS THE RESPONSIBILITY OF THE BUILDER TO NOTIFY THE OWNER OF ANY OMISSIONS OR ERRORS.

DIMENSIONS ALWAYS TAKE PRECEDENCE OVER SCALED MEASUREMENTS. DO NOT SCALE THESE DRAWINGS.
ANY VARIANCES WITHIN THESE DRAWINGS AND SPECIFICATIONS, OR FROM CONDITIONS ENCOUNTERED AT THE JOBSITE, SHALL BE RESOLVED BY THE OWNER AND CONTRACTOR PRIOR TO CONSTRUCTION.

THE OWNER AND CONTRACTOR SHALL ENSURE THAT THE CONSTRUCTION COMPLIES WITH ALL NATIONAL, PROVINCIAL AND LOCAL STATUTES, ORDINANCES & REGULATIONS. WINDOW SIZES SHOWN ARE ACTUAL FRAME RSO'S AS REQUIRED. ENSURE EGRESS FOR ALL BEDROOM WINDOWS. CONTRACTOR TO REVIEW DRAWINGS WITH SUBTRADES PRIOR TO CONSTRUCTION.