

Room Specification

General

Structure

Deck

Deck Support

Moldings

Wall Covering

Fill Style

Materials

Components

Schedule

General

Room Type: Basement

Define...

Room Name: Basement

☒ Show Room Label

Living Area

☐ Include in Total Living Area Calculation

☐ Exclude from Total Living Area Calculation

☒ Use Default (Excluded)

Conditioned Room

☐ Conditioned

☒ Unconditioned

☐ Use Default (Unconditioned)

Options

Roof Group: 0

foundation

Number Style...

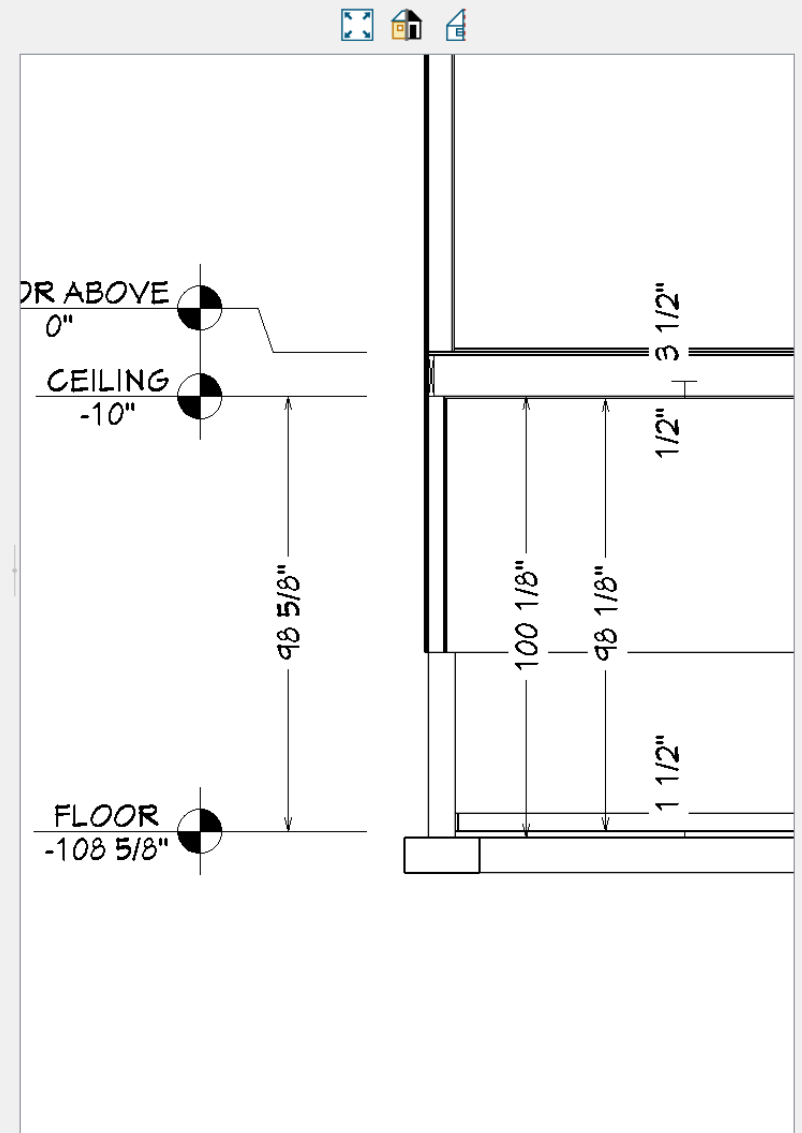

OK

Cancel

Help

Room Specification

General

Structure

- Deck
- Deck Support
- Moldings
- Wall Covering
- Fill Style
- Materials
- Components
- Schedule

Absolute Elevations

Floor Above: No Change 

Ceiling: No Change 

Floor: -108 5/8" 

Floor Below: 0" 

Relative Heights

Rough Ceiling: 98 5/8" 

Finished Ceiling: 98 1/8" 

SWT To Ceiling: 98 5/8" 

Ceiling Below: 0" 

Stem Wall: 100 1/8" 

SWT = Stem Wall Top

 Ceiling values may not be changed as the floor above this room has varying heights.

Ceiling

- ☒ Roof Over This Room
- ☒ Flat Ceiling Over This Room
- ☐ Shelf Ceiling
- ☐ Use Soffit Surface for Ceiling

Ceiling Structure: 3 1/2"  ☒ Default

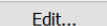
Ceiling Finish: 1/2"  ☒ Default

Floor

- ☒ Floor Under This Room
- ☐ Room Supplies Floor for the Room Above
- ☐ Monolithic Slab Foundation
- ☐ Retain Floor/Ceiling Framing

Slab Pour Number / Framing Group: 1 

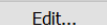
Floor Finish: 0"  ☒ Default

On Structure Resize: ☒ Lock Floor Top ☐ Lock Floor Bottom

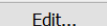
Floor Structure: 1 1/2"  ☒ Default

Number Style...

basement / foundation

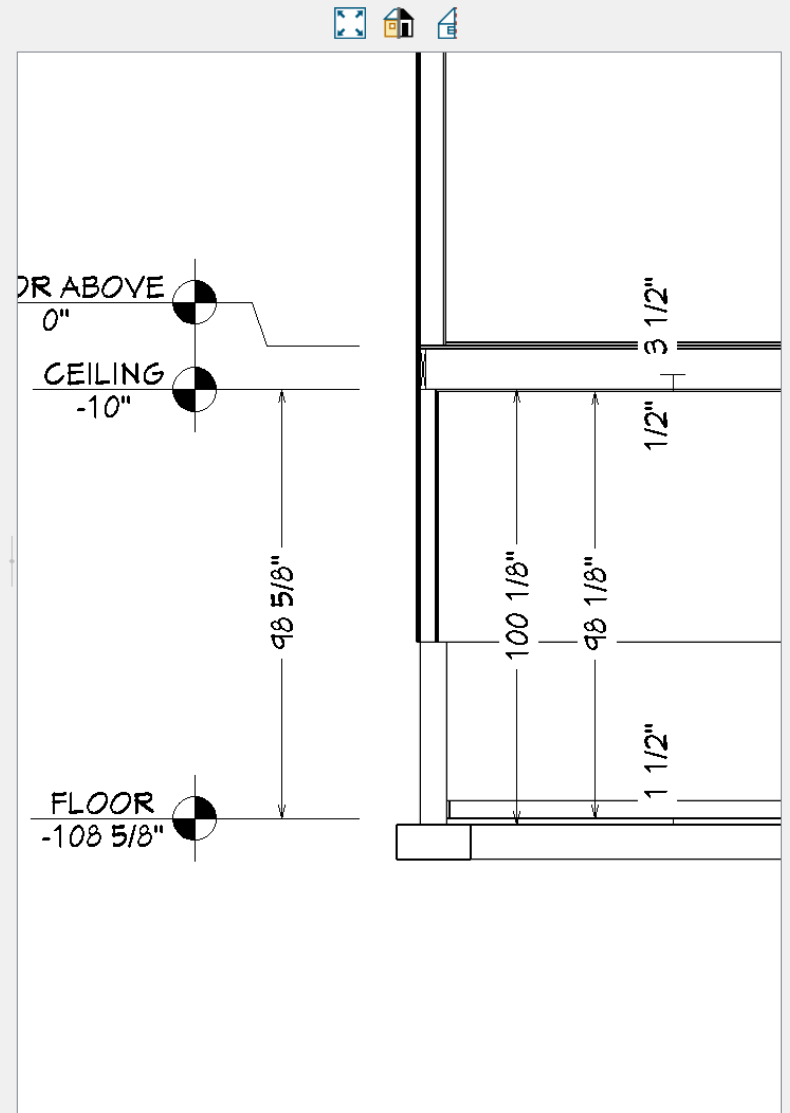

OK

Cancel

Help

Room Specification

General

Structure
Deck
Deck Support
Moldings
Wall Covering
Fill Style
Materials
Components
Schedule

General

Room Type: Living Room

Define...

Room Name: Living Room

☒ Show Room Label

Living Area

- ☐ Include in Total Living Area Calculation
☐ Exclude from Total Living Area Calculation
☒ Use Default (Included)

Conditioned Room

- ☐ Conditioned
☐ Unconditioned
☒ Use Default (Conditioned)

Options

Roof Group: 0

main floor

Number Style...

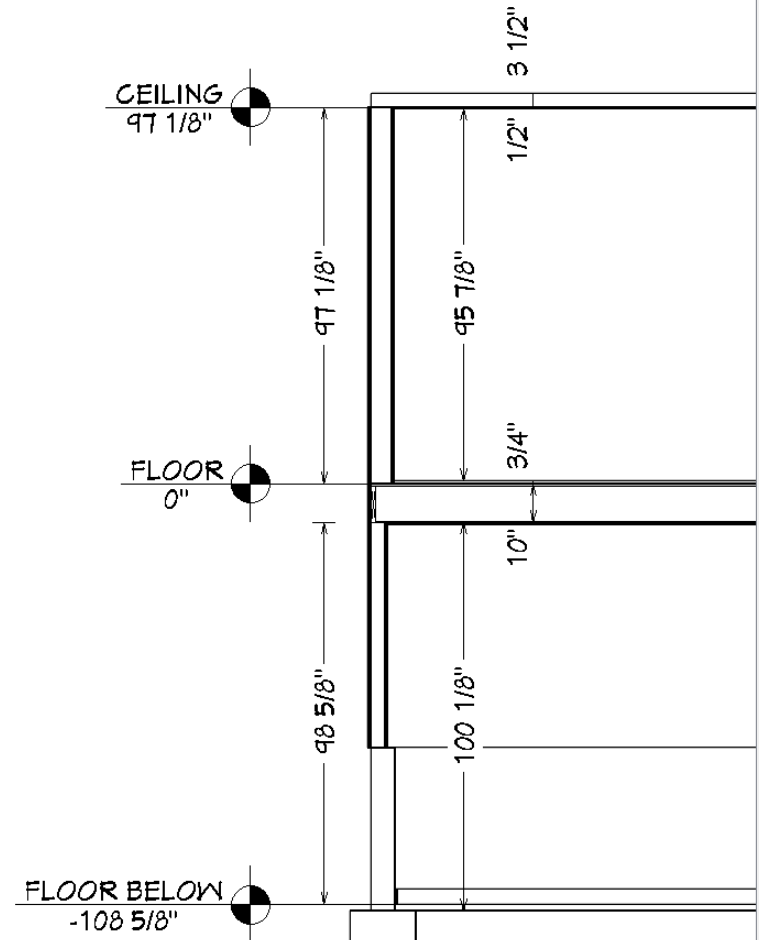

OK

Cancel

Help

General

Structure

Structure

Deck

Deck Support

Moldings

Wall Covering

Fill Style

Materials

Components

Schedule

Absolute Elevations

Floor Above: 100 5/8" 

Ceiling:	97 1/8"	
----------	---------	---

Floor: 0" 

Floor Below: -108 5/8" 

Relative Heights

Rough Ceiling: 97 1/8" 

Finished Ceiling: 95 7/8" 

SWT To Ceiling: 97 1/8" 

Ceiling Below:	98 5/8"	
----------------	---------	---

Stem Wall: 100 1/8" 

SWT = Stem Wall Top

Ceiling

- ☒ Roof Over This Room
☒ Flat Ceiling Over This Room
☐ Shelf Ceiling
☐ Use Soffit Surface for Ceiling

Ceiling Structure:	3 1/2"	Edit...	<input checked="" type="checkbox"/> Default
--------------------	--------	---------	---

Ceiling Finish:	1/2"	Edit...	<input checked="" type="checkbox"/> Default
-----------------	------	---------	---

Floor

- ☒ Floor Under This Room
☐ Floor Supplied by the Foundation Room Below
☐ Monolithic Slab Foundation
☐ Retain Floor/Ceiling Framing

Slab Pour Number / Framing Group: 1

Floor Finish: 3/4" Edit... ☒ Default

On Structure Resize: ☒ Lock Floor Top ☐ Lock Floor Bottom

Floor Structure: 10" Edit... ☐ Default

main floor

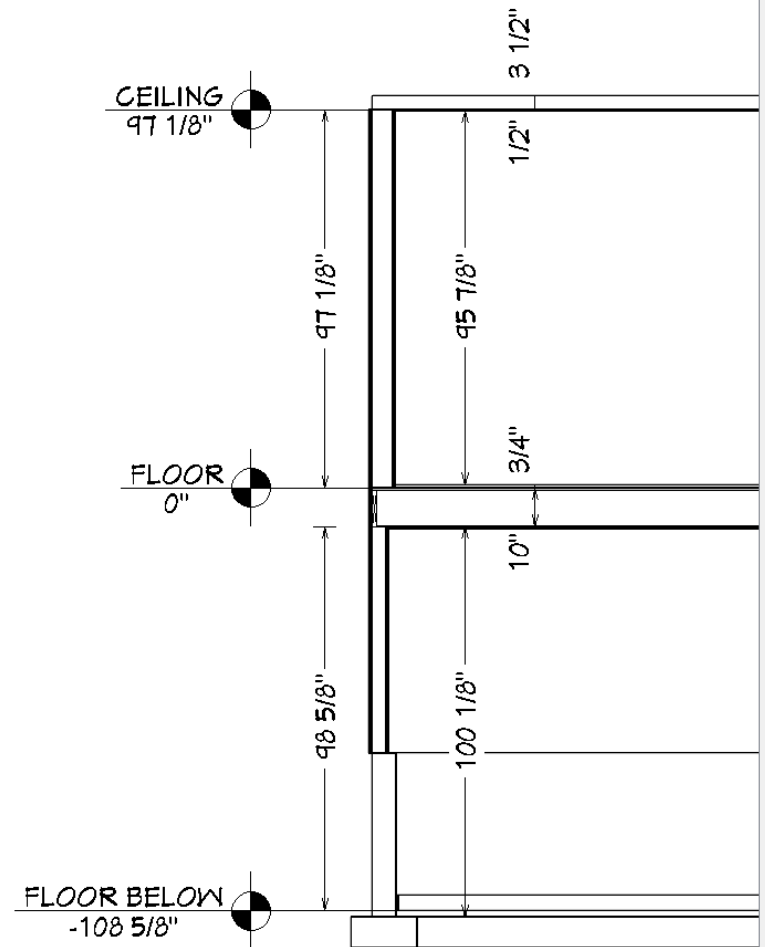

Room Specification

General

Structure

Deck

Deck Support

Moldings

Wall Covering

Fill Style

Materials

Components

Schedule

Absolute Elevations

Floor Above: 100 5/8"

Ceiling: 97 1/8"

Floor: -58 5/8"

Floor Below: -108 5/8"

Relative Heights

Rough Ceiling: 155 3/4"

Finished Ceiling: 154 1/2"

SWT To Ceiling: 155 3/4"

Ceiling Below: 98 5/8"

Stem Wall: 100 1/8"

SWT = Stem Wall Top

foyer - lower floor

Ceiling

- ☒ Roof Over This Room
- ☒ Flat Ceiling Over This Room
- ☐ Shelf Ceiling
- ☐ Use Soffit Surface for Ceiling

Ceiling Structure: 3 1/2" ☒ Default

Ceiling Finish: 1/2" ☒ Default

Floor

- ☒ Floor Under This Room
- ☐ Floor Supplied by the Foundation Room Below
- ☐ Monolithic Slab Foundation
- ☐ Retain Floor/Ceiling Framing

Slab Pour Number / Framing Group: 1

Floor Finish: 3/4" ☒ Default

On Structure Resize: ☒ Lock Floor Top ☐ Lock Floor Bottom

Floor Structure: 8" ☐ Default

Number Style...

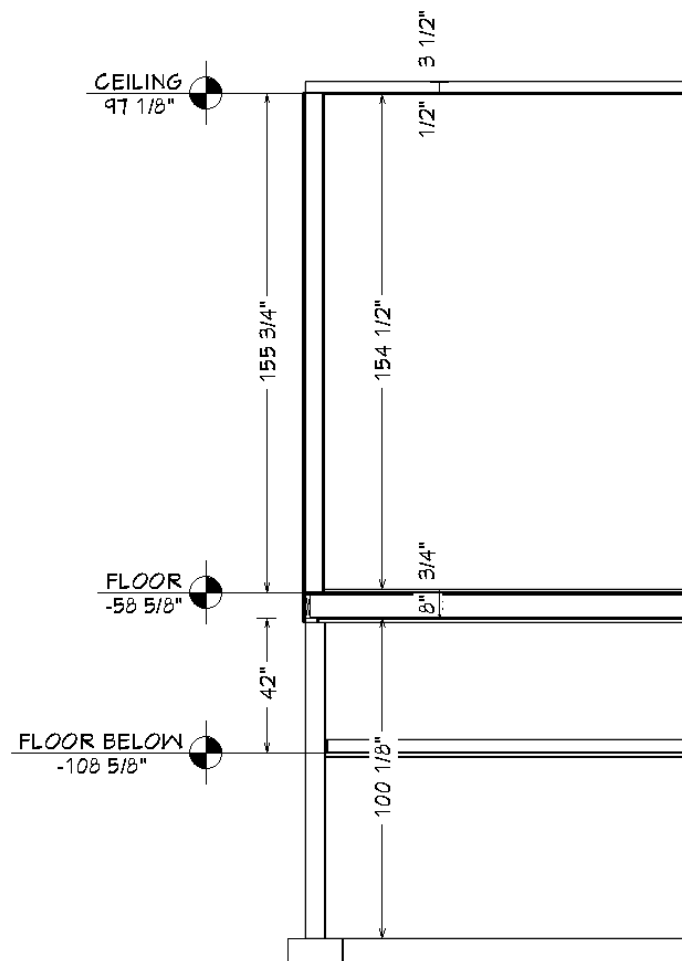

OK

Cancel

Help

Room Specification

General

Structure

Deck

Deck Support

Moldings

Wall Covering

Fill Style

Materials

Components

Schedule

General

Room Type:

Define...

Room Name:

☒ Show Room Label

Living Area

- ☐ Include in Total Living Area Calculation
☐ Exclude from Total Living Area Calculation
☒ Use Default (Included)

Conditioned Room

- ☐ Conditioned
☐ Unconditioned
☒ Use Default (Conditioned)

Options

Roof Group:

lower floor with 7-1/4 floor joist

Number Style...

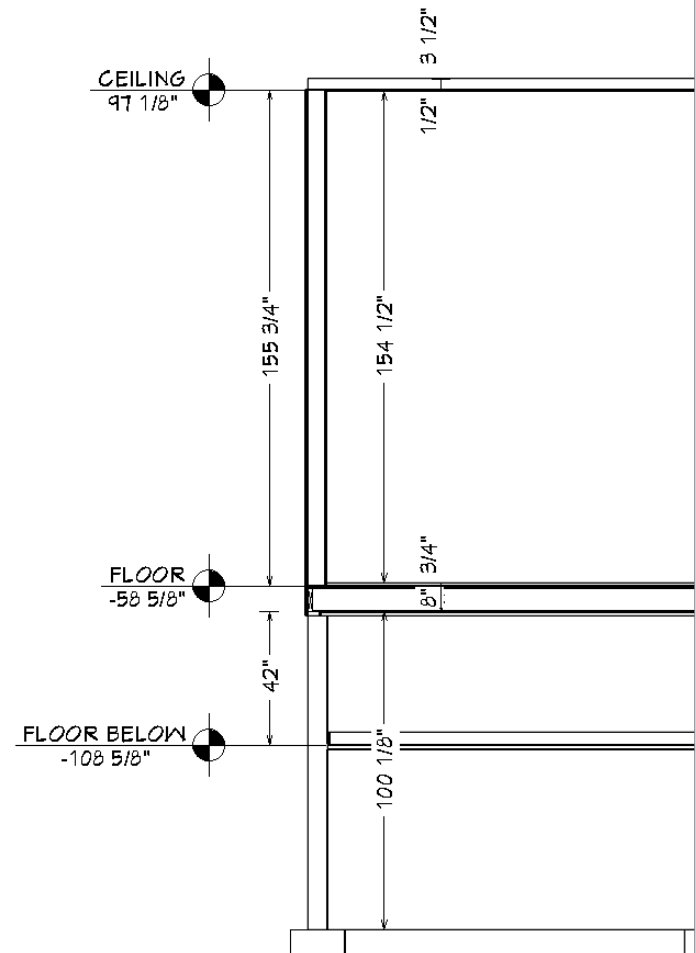

OK

Cancel

Help

Wall Specification

General

Structure

Roof

Foundation

Wall Types

Wall Cap

Wall Covering

Rail Style

Newels/Balusters

Rails

Layer

Materials

Label

Components

Object Information

Schedule

General

Wall Type:

Exterior-4

Define...

☒ Pony Wall

Lower Wall Type:

6" Concrete Stem Wall

Define...

Elevation of Lower Wall Top:

-68 1/8"

Height Off Floor:

40 1/2"

Align Pony Wall at:

☐ Outer Surface

☒ Main Layer Outside

☐ Wall Center

☐ Main Layer Inside

☐ Inner Surface

Display In Plan View:

☐ Default

☐ Upper Wall

☐ Lower Wall

☐ Upper Wall and Lower Wall Outline

☐ Upper Wall Outline and Lower Wall

☒ Upper Wall and Lower Wall

Number Style...

OK

Cancel

Help

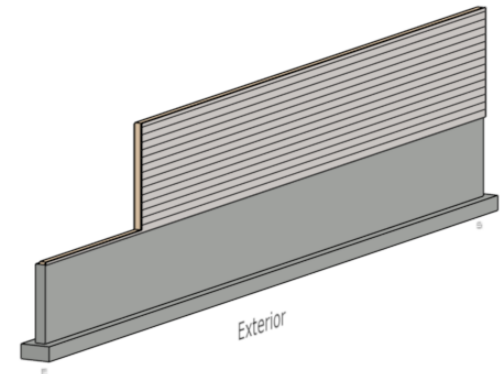

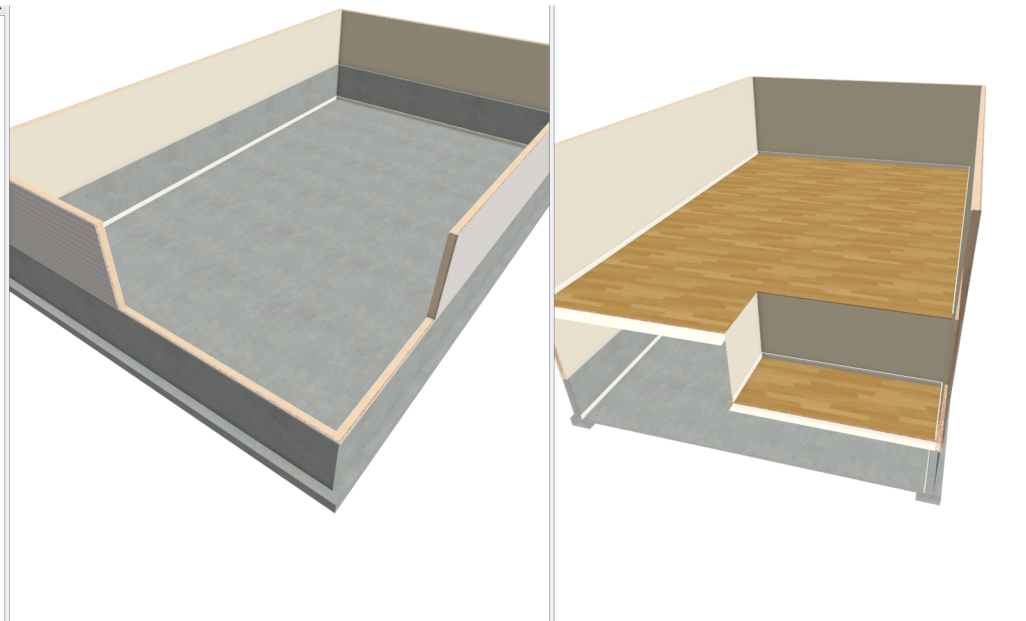
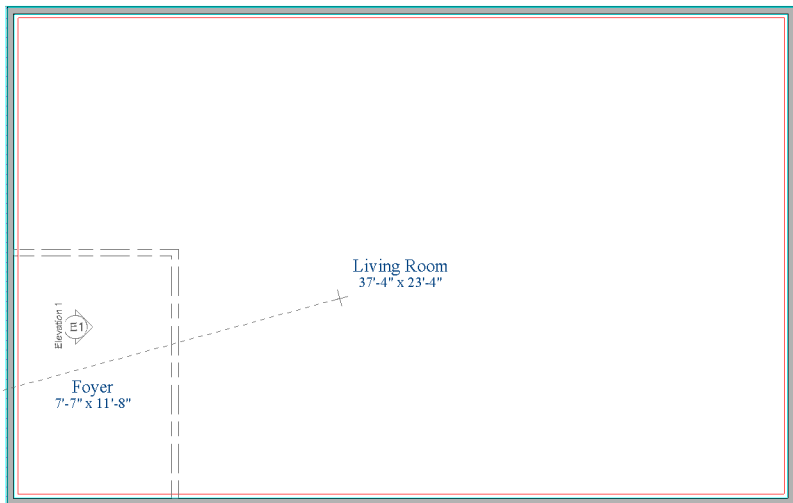

Bi Level: Cross Section/Elevation - Elevation 1

