

STUCCO/ WATERMASTER SYSTEM

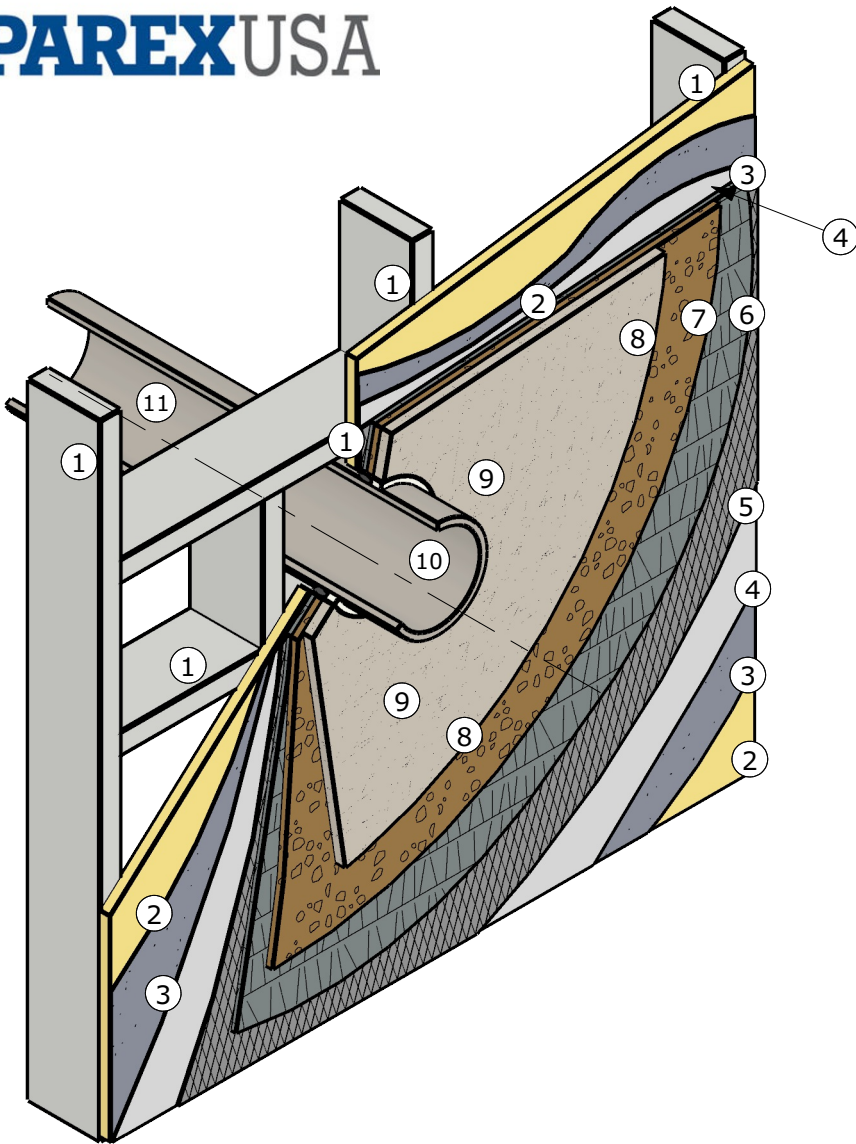

KEY NOTES

- ① STRUCTURAL FRAMING
- ② SUBSTRATE (GP-DENSGOLD)
- ③ PAREX USA WATER-RESISTIVE AND AIR BARRIER COATING
- ④ WATER-RESISTIVE BARRIER SHEET¹
- ⑤ EXPANDED METAL LATH PER ASTM C1063
- ⑥ PAREX USA BASE COAT²
- ⑦ PAREX USA PRIMER (OPTIONAL - FOR USE WITH ACRYLIC OR ELASTOMERIC FINISH; NOT CEMENTITIOUS FINISHES)
- ⑧ PAREX USA FINISH
- ⑨ CONTINUOUS SEALANT (BY OTHERS)
- ⑩ INTERIOR AIR SEAL (BY OTHERS)
- ⑪ PLANNED PENETRATION (BY OTHERS)

G1.07 STUCCO ASSEMBLY / WATERMASTER PLANNED STUCCO PENETRATION (ISO)

PAREX ARMOURWALL 100 & 300, LAHABRA FASTWALL 100 & 300, EL REY FASTWALL & FIBER-47, TEIFS ONE COAT & SCRATCH & BROWN
☐ HE ☐ KRAK-SHIELD ☒ WATERMASTER

1. STUCCO CLADDINGS & ANY CLADDINGS USING A MORTAR BED REQUIRE THE USE OF A SLIPSHEET INSTALLED OVER THE WATER-RESISTIVE & AIR BARRIER COATING TO PREVENT ADHESION TO THE STUCCO.
2. REFER TO PAREX USA SPECIFICATIONS FOR SPECIFIED BASECOAT PRODUCT & THICKNESS.
3. DO NOT APPLY FINISH COAT ONTO SURFACES TO RECEIVE SEALANT.
4. TO ENSURE A CONTINUOUS AIR BARRIER ACROSS THE BUILDING ENVELOPE, A CONTINUOUS AIR SEAL SHOULD BE MADE AT EACH SUBSTRATE CHANGE, JOINTS/GAPS, PENETRATIONS & DISSIMILAR MATERIAL TERMINATIONS. THESE MUST BE A CONSIDERATION OF THE DESIGNER IN THE OVERALL WALL ASSEMBLY DESIGN.

Disclaimer: The design, specifications, and construction shall comply with all local building codes and standards. Parex USA installation guidelines are for general information and guidance only and Parex USA specifically disclaims any liability for the use of this design, and for design, engineering, or workmanship of any project. The assembly shall be designed to prevent condensation within the assembly. The designer and the user shall provide final drawings and specifications. Products shown other than those manufactured by Parex USA are shown for clarity of the Parex USA product only. Contact the manufacturer of such other products for installation instructions.